

← 3 1/4 Miles to Manitowish, Wis.

U.S. Highway 51

- 1 BARRACK 1
- 2 " 2
- 3 " 3
- 4 " 4
- 5 " 5
- 6 KITCHEN & MESS HALL
- 7 BATH HOUSE
- 8 LIBRARY & ED. ADVISER
- 9 CANTEN
- 10 RECREATION HALL
- 11 ROOT CELLAR
- 12 PUMP HOUSE
- 13 HIGH JUMP PIT
- 14 BROAD JUMP PIT
- 15 VOLLEY BALL CT.
- 16 " " "
- 17 "DIANE", THE DEER'S CAGE
- 18 HORSE SHOC CT'S.
- 19. PUNCHING BAG
- 20. RANGER'S QUARTERS

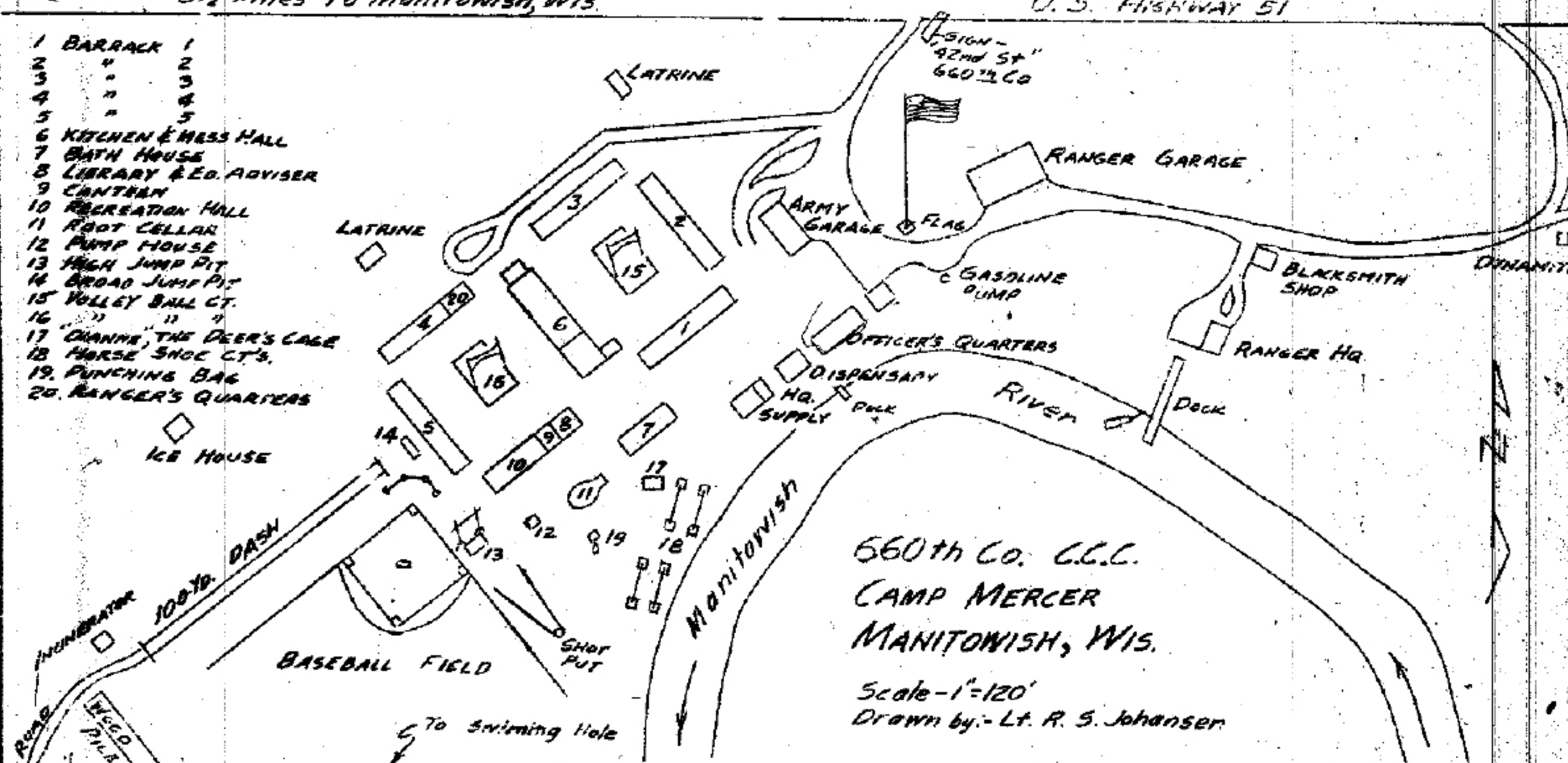

660th Co. C.C.C.  
 CAMP MERCER  
 MANITOWISH, WIS.

Scale - 1" = 120'  
 Drawn by: - Lt. R. S. Johansen

⚡ To Swimming Hole